

SPECIFICATION

HANSE

675



LOA	21.10 m 69'2"
Hull length	20.50 m 67'3"
LWL	19.20 m 63'0"
Beam	5.90 m 19'4"
Draft	3.10 m 10'2" (standard) 2.70 m 8'9" (option)
Displacement	approx. 34.50 t approx. 76,059 lb (standard keel) approx. 35.50 t approx. 77,161 lb (L shape keel)
Ballast	approx. 10,960 kg approx. 24,162 lb (standard) approx. 12,000 kg approx. 26,455 lb (option)
Engine	Diesel approx. 107 KW / 146 HP
Fresh water	approx. 980 l
Fuel tank	approx. 1,100 l
CE Certificate	A (ocean)
Mast length above WL	approx. 31.95 m approx. 104'8"
Main sail	approx. 132.00 m ² approx. 1,420 sq ft
Self-tacking jib	approx. 98.00 m ² approx. 1,054 sq ft
Genoa 140%	approx. 165.00 m ² approx. 1,776 sq ft
Gennaker	approx. 280.00 m ² approx. 3,013 sq ft
Rig	I: 27.30 m 89'6" J: 7.75 m 26'4" P: 26.50 m 86'9" E: 9.10 m 29'8"
Design	judel / vrolijk & co
Interior	HanseYachts Design

Modell year 2016/2017 – valid 01.07.2016

All specifications and prices are preliminary and can be changed without prior warning. Above specifications are non-contractual.

STANDARD
A1 | B1 | C1 | D1

OPTIONS
A1 | B2 | C1 | D2

A2 | B3 | C1 | D3

A3 | B4 | C1 | D2

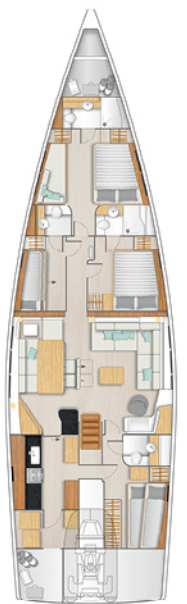
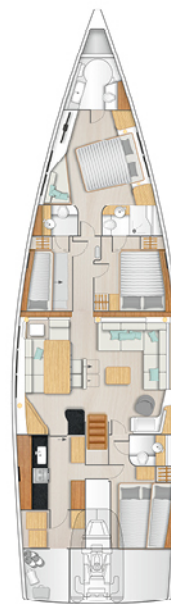
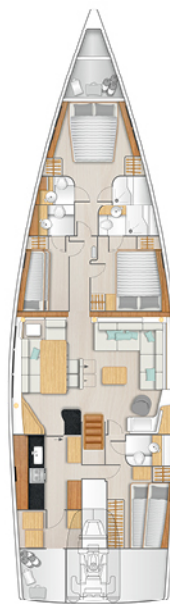
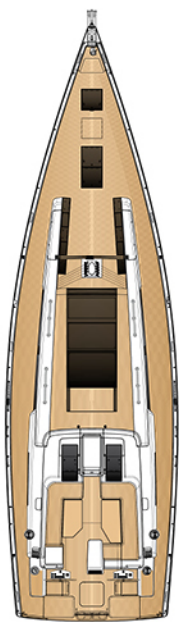

STANDARD EQUIPMENT

HANSE
675

HULL

- White hull
- GRP sandwich core construction
- Dark grey double waterlines
- Options for different hull colour according to Hanse colour selection
- Isophthalic Gelcoat
- Vinylster for all outer laminates
- Polyester inner laminate (Orthophthalic or DCPD)
- Bulkheads laminated to hull (main bulkhead laminated to hull and deck)
- Main bulkheads made out of composite
- GRP strongback
- 14 Hull windows

DECK

- White deck with non slip structure
- Isophthalic Gelcoat
- Vinylster outer layer
- Bulk laminate Polyester (Orthophthalic or DCPD)
- Balsa sandwich

STEERING SYSTEM

- Redundant twin wheel steering system
- 2 leather covered stainless steering wheels
- Steering pedestals with instrument consoles
- Semi-balanced, profiled rudder with alloy shaft and selfaligning needle bearings
- Compass at each helm

KEEL

- Standard: L shape iron keel draft: 3.10 m
- Option: L shape iron/lead keel draft: 2.70 m
- Stainless steel keel bolts

DECK EQUIPMENT

- Teak on seats and cockpit floor
- Partial moulded non-skid surface on the coach roof and side decks
- Lifting entrance door with lock.
- Second entrance to utility room storage area and galley.
- Engine control at helm station stb
- 8 retractable mooring cleats
- Self-draining chain locker with electrical windlass (2000W) on deck
- Fixed double anchor arm with anchor roller and integrated fittings for 2 forstays plus ring for genacker
- 2 cockpit tables with folding teak leaves
- Cockpit with U-shape and L-shape cockpit benches.
- Wetbar in cockpit with sink and dedicated space for optional grill and fridge.
- 2 folding helmsman seats???
- Foredeck storage behind chain locker with deckhatch
- Foredeck sail storage with ladder and big hatch only in A1 and A3 layout
- Hot & cold shower on aft deck
- Halyard storage bags in the cockpit
- Storage for gas 2 bottles, selfdraining
- Stainless steel swim ladder
- Longitudinal dinghy garage
- Self-tacking jib track, fully integrated in the foredeck
- Midboom sheeting with 2 stand-up blocks
- 2 x 5 sheave deck organizers
- 10 deck jammers??
- 2 genoa tracks with pin stop cars
- 6 padeyes for gennaker, jib
- 12 Flush hatches
- Large glass openable roof in saloon.
- 2 portholes for aft cabin and galley
- 4 opening side windows for saloon at coach roof
- 4 opening side windows for galley and aft cabin at coachroof
- Stainless steel pushpit with LED navigation light and ensign shaft socket
- Stainless steel pulpit with LED navigation lights
- Stainless steel stanchions tapered
- Rail gates on both sides
- 4 winches in cockpit:
2 primary winches 65 CEST Lewmar evo electric
2 secondary winches 65 AST Lewmar evo

TECHNICAL SYSTEM

PLUMBING SYSTEM / FRESH WATER

Tank

- 2x Fresh water tanks, total capacity approx. 1.000 l
- Water infill on deck

Hot water

- 80 l water heater, running from engine and immersion heater 230 V

DRAINING PUMPS

Bilge pumps

- 1 manual bilge pump
- 1 electric bilge pump with hose for compartments
- 4 electric bilge pump with automatic switch

Toilet / Head

- 1 electric toilet in owners cabin
- Manual marine toilets for other heads
- Holding tanks with sea and deck discharge for all toilets total black water capacity approx.300 ltrs

ENGINE

- Diesel approx. 107 KW / 146 HP, shaft drive
- 4 bladed folding propeller
- 2 Fuel tanks, total capacity approx. 1100 l
- 1 alternator 12v / 180 Amp
- 1 alternator 24v / 150 Amp
- Fuel infill on deck
- Fuel filter / Water separator
- Engine room sound insulated and illuminated
- Bowthruster retractable, incl own battery and charger.

ELECTRIC SYSTEM

- 24 V DC and 230 V AC

Bus system

- State of the art centralized multiplex BUS system (Czone). It controls all DC circuits and monitors all ships functions
- Central computer with touch screen panel at navigation station with pre-programmed standard combinations of functions (program factory locked)
- Back up small display in owners cabin

Batteries

- Remote controlled battery switches for easy handling
- Engine battery: 12 V / 90 Ah AGM
- Service battery: 4x 260 Ah AGM(12v) total 520Ah at 24V

Battery charger / Shore power

- 230 V shore supply protected with differential breaker and distribution system
- Wisper power inverter 230V 7000Watt
- Battery charger 150 A at 24V

24 V Electric equipment

- Electrical anchor windlass
- Pumps
- Navigation lights LED
- Interior lights
- Refrigerator
- 2x electrical winches
- Opening sliding roof in saloon electrical

Outlet 230 V

- at chart table twin outlet
- 2 additional twin outlets in saloon
- 1 twin outlet at bar.
- 1 twin outlet in each guest cabin and/ or office.
- 1 Singel outlet in each head
- 2 twin outlets in forward cabin
- 2 twin outlets in galley
- 1 twin outlet in aft cabin
- 1 singel outlet in utility room

Outlets 12 V

- at chart table
- at helm station

Interior lighting

- Overhead lighting in cabins, saloon, galley and heads
- Lighting in engine compartment
- Reading lights in saloon and cabins
- Courtesy light on companion way
- Indirect lights in saloon and cabins

Navigation lights

- Navigation lights LED on pulpit and pushpit

- Steaming light with decklight
- Anchor light

Navigation instruments

- 2 illuminated compasses at each helm

GALLEY

- Solid Coriean surface, black quartz with integrated double sink
- 3-burner LPG stove with oven and grill, gimble
- Ventilation hood
- LPG Gas system
- Double drawer fridge, totalling 140 l
- Lockers and drawers
- Waste bin
- Option for microwave
- Option for freezer/ice maker
- Option for dishwasher
- Option for washing machine

INTERIOR ACCOMMODATION

- High quality marine plywood, Mahogany Style, satin varnish
- White bulkheads
- Wooden door frames
- Wood / Sandwich doors
- Acacia style floorboards

Upholstery

- According to Hanse colour selection

Sail Storage

- Version A1 foredeck sail storage with ladder and big hatch
- In all versions locker in bow with hatch from deck which also gives access to chainlocker.

Forward cabin

- Version A1 Owner cabin with island berth, extensive hanging lockers and drawers including a separate head and separate shower unit in owners state room.
- Optional layouts according to Hanse Individual Cabin Concept

Guest cabin(s)

- B1
- VIP cabin on Starboard with large double berth, locker and own toilet en ensuite shower.
- Office on portside with desk seat and lockerspace
- Optional layouts according to Hanse Individual Cabin Concept

All measurements are approximate. Specification and material can be changed without notice.

STANDARD EQUIPMENT

HANSE
675

Main Saloon

- Version C1
- Large saloon table on portside
- Slideable seat with fixed backrest in the middle of the saloon.
- Lockers and storage spaces
- L-shaped sofa on starboard side with sliding seats to convert the seat in a chaise lounge.
- Bar on portside with space for coffee machine, wine fridge and icemaker.

Navigation area

- Comfortable navigator's seat (turnable)
- Locker next to chart table for instruments
- Space to mount electronics and large TV
- 230 V / 12 V outlet
- Storage in the chart table
- Chartable light
- Storage locker next(below) to the chart table

Aft cabin

- Version D1
- Skipper/guest cabin on portside with double bunk berth foldable table own toilet with shower and washbasin.
- Excess from cabin on portside to saloon and directly to galley.
- Optional layouts according to Hanse Individual Cabin Concept

Galley

- Galley on portside aft.
- Long worktop alongside the hull
- Numerous lockers and shelves for storage
- Space for all appliances.
- Hull window for additional light
- 3 burner stove with oven
- Mixertap
- Double sink

RIGG AND SAILS

- 3 spreader silver anodised keel stepped furling mast, tapered
- Electric hydraulic furling for mast
- Manual Furling system for selftacking jib
- Jib halyard steel wire on mast with tensioner
- Midboom sheeting with 2 stand-up blocks
- Jib sheet
- Hydraulic Boomvang
- Hydraulic Backstay adjuster
- Optional sails from elvström

All measurements are approximate. Specification and material can be changed without notice.